

## REMOVAL

### HINT:

- Use the same procedures for the RH side and LH side.
- The procedures listed below are for the LH side.

### NOTICE:

- If the wiring connector of the SRS is disconnected with the ignition switch in the ON position, DTCs will be recorded.
- Never use airbag parts from another vehicle. When replacing parts, replace them with new ones.
- Never reuse a side airbag sensor assembly if the airbag has previously deployed in a collision.

1. PRECAUTION (SEE PAGE RS-1 AND RS-3)
2. DISCONNECT CABLE FROM NEGATIVE BATTERY TERMINAL

Wait for 90 seconds after disconnecting the cable to prevent the airbag working.

3. REMOVE FRONT DOOR SCUFF PLATE (SEE PAGE BO-133)
4. REMOVE REAR DOOR SCUFF PLATE (SEE PAGE BO-133)
5. REMOVE FRONT SEAT OUTER BELT FLOOR ANCHOR (SEE PAGE BO-133)
6. REMOVE CENTER PILLAR LOWER GARNISH (SEE PAGE BO-133)
7. REMOVE FRONT SEAT OUTER BELT RETRACTOR (SEE PAGE BO-236)

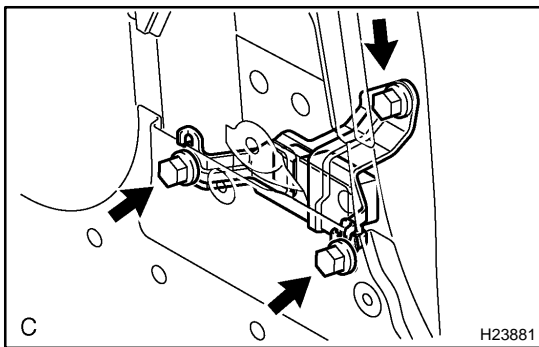

8. REMOVE SIDE AIRBAG SENSOR ASSEMBLY LH
  - (a) Disconnect the connector from the side airbag sensor assembly LH.
  - (b) Remove the 3 bolts and the side airbag sensor assembly LH.